

An aerial photograph of a tropical island with lush green vegetation and a white sandy beach. The water is a vibrant turquoise color, transitioning to a deeper blue further out. A small sailboat is visible in the middle of the water. In the background, there are more islands and a large mountainous island under a blue sky with scattered white clouds.

BURMA BOATING
Ultimate Archipelago Adventures

Anambas Islands

Cabin Charter Cruises – Summer 2020

An aerial photograph of a tropical beach. The water is a vibrant turquoise color, transitioning to a lighter shade near the shore. A small, white inflatable boat with two people is in the water. The beach is white sand, and there are large, light-colored rocks and lush green vegetation on the right side.

The Ultimate Archipelago Adventure

BAREFOOT LUXURY - PRISTINE BEACHES & ISLANDS - UNIQUE EXPERIENCES

LUXURY EQUIPEMENT & AMENITIES - GUIDED ADVENTURE - EXPERIENCED CREWS & CHEFS

FRESH DAILY CATCH - NATURE & CULTURE DISCOVERIES

ENVIRONMENTALLY CONSCIOUS HOLIDAYS

The Anambas Islands

The Anambas islands are a group of 255 pristine islands located in the Riau Archipelago, the South China Sea between Singapore and Borneo.

Only few of these islands are sparsely populated with local fishing villages, and barely known to the outside world. These unspoiled islands are surrounded by crystal clear warm waters and coral reefs, hosting abundant sea-life with unrivaled snorkeling and diving.

Turtles, black tip reef sharks, large school of pelagic fishes, manta rays and even whale sharks are common in the region.

Ideal anchorages, post cards perfect lagoons, white sandy beaches and dramatic waterfalls round out one of our planets last unknown archipelagos. Due to its beauty and rich marine biodiversity, the Anambas islands have been declared a new Indonesian National Marine park in 2011.



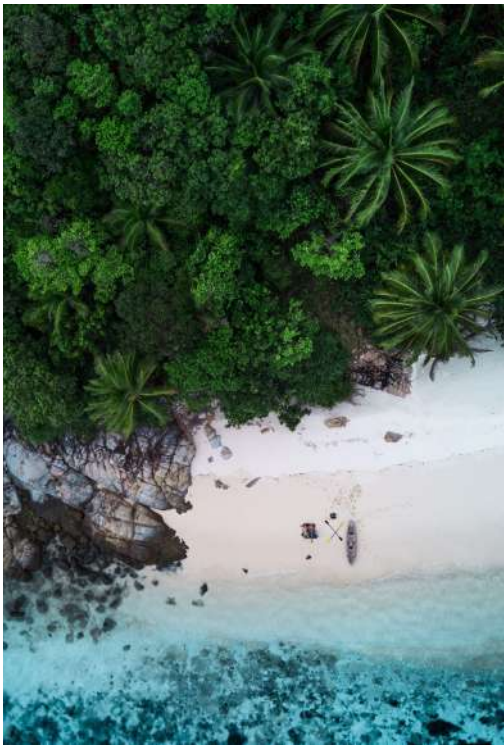

Explore an unchartered territory

Chinese and European sailors first discovered this vast marine territory several centuries ago, but the region remains a great exploration playground for sailors, divers and nature lovers.

Once arriving in Letung airport it becomes clear that you are one of the first sailors to explore this unchartered territory. During the approach aboard the plane you will see the closely scattered islands within the Archipelago that boast with hundreds of bays and beaches for anchorage.

Whether you're an experienced sailor or on board a ship for the first time, you will love the Anambas Islands, an area so versatile and large that you can beach hop for weeks on end or go on multi-day blue-water passages. Or both, of course. Be one of the first to join us discover and explore this amazing and untouched region!



""A yacht like a floating boutique hotel."

Spiegel



5 Nights / 6 Days itinerary "Anambas Sailing Discovery"



DAY 1 – The adventure starts from **Letung Airport, Jemaja island**, we will pick you up and transfer you by car to the beach, then onwards by dinghy to the yacht. Welcome aboard, where our crew is waiting for you with welcome drinks, check-in on board and safety briefing. Short motor sail to Two Hands Bay on **Pulau Anak**, arrival and anchor to the bay, time to swim, snorkel and beach walk before sunset drinks watching turtle mating on the beach, just within meters of the yacht! The Two Hands Bay has a spectacular finger reef where large school of fish, turtles, amazing corals and an impressive variety of seashells (cowries, vases, harp, cone) can be seen.

DAY 2 – Morning swim for the early risers, followed by a full breakfast prepared by your crew. Set sail to the north east corner of the archipelago (5h sail) to reach **Nongkat island**, which has a fantasy-like rock lagoon enclosing a small Indonesian resort. Lunch served en-route with a good chance of catching a large tuna, spanish mackerel or barracuda on the lures during this sail. Afternoon can be enjoyed with a pleasant drink at the shaded beach bar at the resort, or swimming, snorkeling, paddle boarding or just lazing about. Sunset cocktail & dinner on board.

DAY 3 – Breakfast on board follow by a short 2h sail to the north eastern most islands of the Anambas, **Pulau Pendjalin**. This very remote picturesque anchorage has exceptionally clear water and amazing swimming and snorkelling. You will spend the day enjoying this corner of paradise.

DAY 4 – Arrival before lunch to the next location, **Pulau Getok**. This incredible tropical island fringed by pristine coral reef with a private sandy beach. A shallow, sheltered bay a short dinghy ride away has a majestic coral heads, schools of juvenile black tip reef sharks and passing schools of pelagic fish. Following lunch, you will spend the afternoon exploring Getok, snorkelling, kayaking and paddle boarding.

DAY 5 – Early morning departure from **Getok** for a long sail across the islands to reach **Tucan Bay** on the east side of **Pulau Jemaja**. This entire bay is a great natural swimming pool with scattered isolated coral reefs.

DAY 6 – Leaving in the morning for a short sail back to our starting point on the north of **Jemaja Island**. Enjoy you last meal and drinks on board before disembarking your yacht. Our crew will transfer you to airport by car for your flight back to Batam.

*Sample itinerary - can be modified by the captain according to the weather conditions





SY Meta IV

Our flagship Meta IV was designed by the naval architect Thomas E. Colvin, who gave the vessel her beautiful shape and robust hull. She is made entirely of Thai teak, one of the best woods for building classic boats.

Boat Type	Classic Ketch
Year build	1998
Last refit	2019
Flag State	Myanmar
Length (LOA)	85ft / 25.9m
Beam (width)	18ft / 5.4m
Speed	6-11 knots
Passengers	8/9 guests (4 cabins: 1 owner's suite, 2 doubles & 1 twin)
Air Condition	Available
Electricity	12V / 220V
Crew	4 (1 captain, 1 chef, 1 guide, 1 deckhand)
Equipment	Water maker - Espresso machine - 8 Pax dinghy - 2 double kayaks - SUP - Snorkeling equipment - fishing gear - beach games - board games - portable sound system.

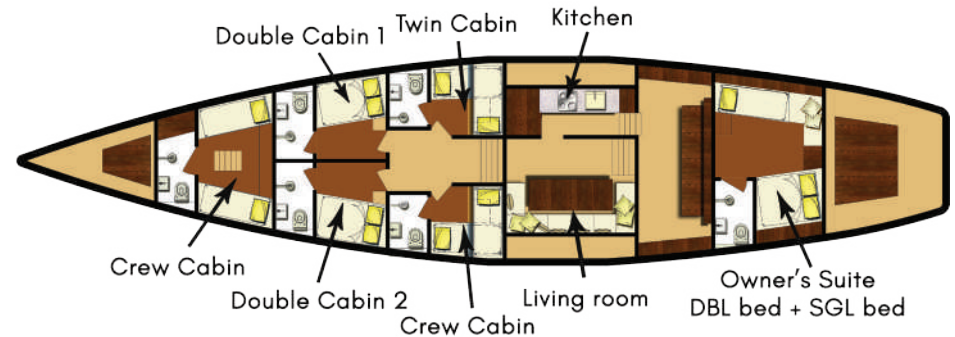



SY Aventure

Aventure is an extremely classy yacht built completely of mahogany and teak. All fittings and decorative elements are custom-built.

Below deck, Aventure is equipped with a 400 hp engine, two generators and the latest gadgets, instruments and facilities you could expect to find on a yacht of her size and style.

Boat Type	Ketch / Classic Yacht
Year build	2011
Last refit	2015
Flag State	Malaysia (Langkawi)
Length (LOA)	95ft / 29m
Beam (width)	6.10m
Speed	8-10 Knots
Passengers	6 guests (3 cabins: 1 owner's suite, 2 doubles)
Air Condition	Available
Electricity	12V / 220V
Crew	4/5 (1 captain, 1 chef, 1 guide, 2 to 3 deckhands)
Equipment	Water maker - 6 pax dinghy - 1 SUP - fishing gear - 2 sea kayaks - snorkeling equipment - BBQ Plancha - board games - portable sound system.

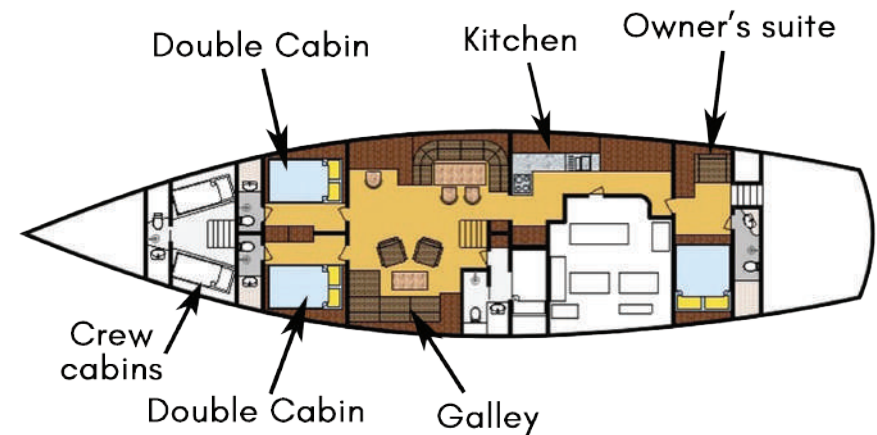



SY Dallinghoo

SY Dallinghoo is a beautiful classic schooner that is fully-decked in teak wood, and is one of the few gaff-rigged wooden yachts present in South-east Asia. She has a vibrant history, is fully-equipped for scuba-diving, and features a classic design perfectly weaved into the romance of a tall ship while boasting the comfort of a modern yacht.

Boat Type	Schooner
Year build	1990
Last refit	2016
Flag State	Malaysia
Length (LOA)	99ft / 30m
Beam (width)	19ft / 5.80m
Speed	8-9 Knots
Passengers	8 guests (4 cabins: 1 owner's suite, 2 doubles & 1 twin)
Air Condition	Available
Electricity	12V / 220V
Crew	5/6 (1 captain, 1 chef, 1 guide, 2 to 3 deckhands)
Equipment	Water maker - 8 pax dinghy - 2 SUP - fishing gear - 4 sea kayaks - snorkeling equipment - scuba gear for 4 pax, Classic gaff-rigged sailing dinghy - TV & movies

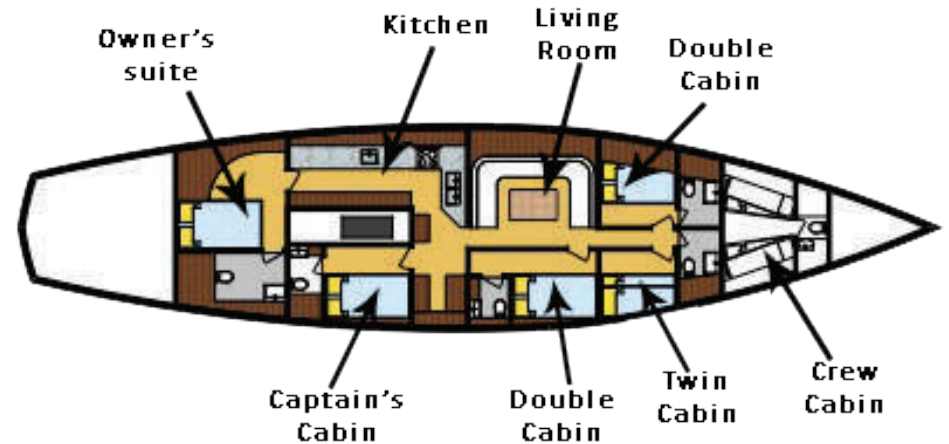



CNN named the Anambas Islands the "Asia's Best Tropical Islands Paradise" in 2013



Getting There is Easy!

All our cruises around the Anambas Islands start from the north beach of Pulau Jemaja, very close by Letung Airport (airport code "LMU") where our crew will pick you up.

From Singapore

From the very well connected airport hub of Singapore, it will take a 3h journey only to reach this heavenly area!

1/ SINGAPORE to BATAM - Reach Batam by ferry boat

Batam is an Indonesian island located only 20km far from Singapore & 15km far from Johor in Malaysia.

From Singapore, many companies offer daily ferries to Batam via various terminals. It's an easy 45 min ferry journey to reach Batam island.

The easiest way to travel

from Singapore to Batam is to take the ferry from terminals "Tanah Merah" or "Singapore Harbour-Front" to "Batam Center Ferry Terminal".

We recommend the following ferry companies: Majestic Ferry (daily departures every hour from 8:10 to 21:20), BatamFast (daily departures every hour from 7:40 to 21:40); Horizon Ferry (daily departures every hour from 8:15 to 21:15). Ferry prices vary between 15 USD to 30 USD/ per way per person depending of the ferry company. **There is a 1h time difference between

Singapore & Batam, Indonesia (1h less for Batam). Once arrived in Batam Center Ferry Terminal and your Indonesian immigration procedures completed, you have to take a taxi to Batam Airport (Hang Nadim Airport, BTH), which is at 10km/ 20 min drive from the ferry terminal. (Taxi price around 10 USD maximum)

2/ BATAM to JEMAJA ISLAND - Fly with Wings Air

From Batam Airport (BTH) to Anambas/Letung Airport (LMU) there are only 4 flights a week (Monday, Wednesday, Friday & Sunday) operated by Wings Air.

Wings Air is a low cost airline branch of Lion Air, they count a fleet of 65 ATR-72 planes, operating short-haul flights widely throughout Indonesian islands and neighbouring countries.

To book your flight from Batam (BTH) to Anambas (LMU) airport, the best is to book directly your ticket on lionAir.co.id or via a flight platform such as traveloka.com or skyscanner.com

Our crew will be waiting for you at Letung Airport and will bring you to the yacht to start your sailing adventure!

F.A.Q

What's included?

- A fully crewed yacht (3 to 6 crew members depending of the yacht, including captain & chef)
- All on-board meals
- All non-alcoholic drinks & sundowners at the end of every day
- All equipment and activities (snorkeling, kayaks, SUP, dinghy...)
- All linen, towels & biodegradable amenities
- All local transfers on the embarkation & disembarkation day

What's Not included?

- Alcoholic drinks
- Visa
- Extra personal expenses & crew tips

What is the departure Time & Place?

Our 5N6D cabin charter cruise leave from Letung on Jemaja Island every Friday between July to September at 2pm.

Do I need to know how to sail?

No. Our experienced crew can do all the sailing for you while you relax. If you like, our crew will be happy to let you get involved or learn sailing during your trip.

What temperature to expect?

During daytime about 28-32°C. The water

temperature between 26-29°C.

What currency should I bring?

The local currency is the Indonesian Rupiah (RP) but USD are commonly used in the region.

Will I need a visa for Indonesia?

Yes. Most foreigners can obtain a Visa Exemption granted for 30 days & free on arrival - 169 nationalities can obtain it.

How are the cabins?

The cabins on a sailing boat are cozy and fully air-conditioned. Cabins have double beds or twin overhead bunk beds. Each cabin has a small and functional en-suite bathroom with sink, toilet and shower. As luggage storage is limited; if you can, please choose soft bags instead of bulky box-like suitcases.

Is there on-board power, fresh water, internet?

Every cabin has power points (plus fans and air-cons). There is fresh water for showering consumption. Generally there is no data connectivity & no internet with the exception of sporadic signals near some local villages.

TRAVEL+
LEISURE

GOURMET
TRAVELLER

Condé Nast
Traveller

FT
FINANCIAL TIMES

NATIONAL
GEOGRAPHIC

TRAVELER

Yacht

LE FIGARO
magazine

Departure Dates 2020

5N6D Cruise - "Anambas Sailing Discovery"

- | | | |
|--|--|---|
| - 3 rd to 8 th July 2020 - | - 31 st July to 5 th August 2020 - | - 4 th to 9 th Sept. 2020 - |
| - 10 th to 15 th July 2020 - | - 7 th to 12 th August 2020 - | - 11 th to 16 th Sept. 2020 - |
| - 17 th to 22 nd July 2020 - | - 14 th to 19 th August 2020 - | - 18 th to 23 rd Sept. 2020 - |
| - 24 th to 29 th July 2020 - | - 21 st to 26 th August 2020 - | - 25 th to 30 th Sept. 2020 - |
| | - 28 th Aug to 2 nd Sept. 2020 - | |

** Cruises operated by SY Meta IV, SY Aventure or SY Dallinghoo

** Other yachts also available for private charter



Memories
GROUP



BURMA BOATING

info@burmaboating.com - www.burmaboating.com